

March 9, 2022

Office of Hopkins County Judge
The Honorable Robert Newsom
Post Office box 288
Sulphur Springs, TX 75483

ONCOR Electric Delivery Coordinator: Jevin Jackson
Service Order Number: WR3571383 2022NSUL003

Dear Judge Newsom,

ONCOR Electric Delivery, LLC is requesting permission to install (2) phases of #2 ACSR to approximately 7100 feet of existing single phase #4 ACSR from Pole 2542527-1303 (33.102855, -95.729739) to Pole 2549527-2306 (33.102642, -95.706633); remove Type 4H 50 Recloser at Pole 2548527-5810 (33.102709, -95.708708); install 13 new mid-span poles, replace 20 existing poles, and service 4 existing poles.

Site location map and construction work prints have been attached. The work prints will show details of the proposed work. There are no road crossings associated with this WR.

Please route questions and approvals to: Paul.Williams@leidos.com

Sincerely,

Jevin Jackson

System Improvement Program Coordinator

Jevin.Jackson@oncor.com

Submitted by:

Paul Williams

Associate Distribution Engineer

Paul Williams 3-14-2022

OnCOR |
1606 Woodall Rodgers Freeway
Dallas, TX 75202
OnCOR.com

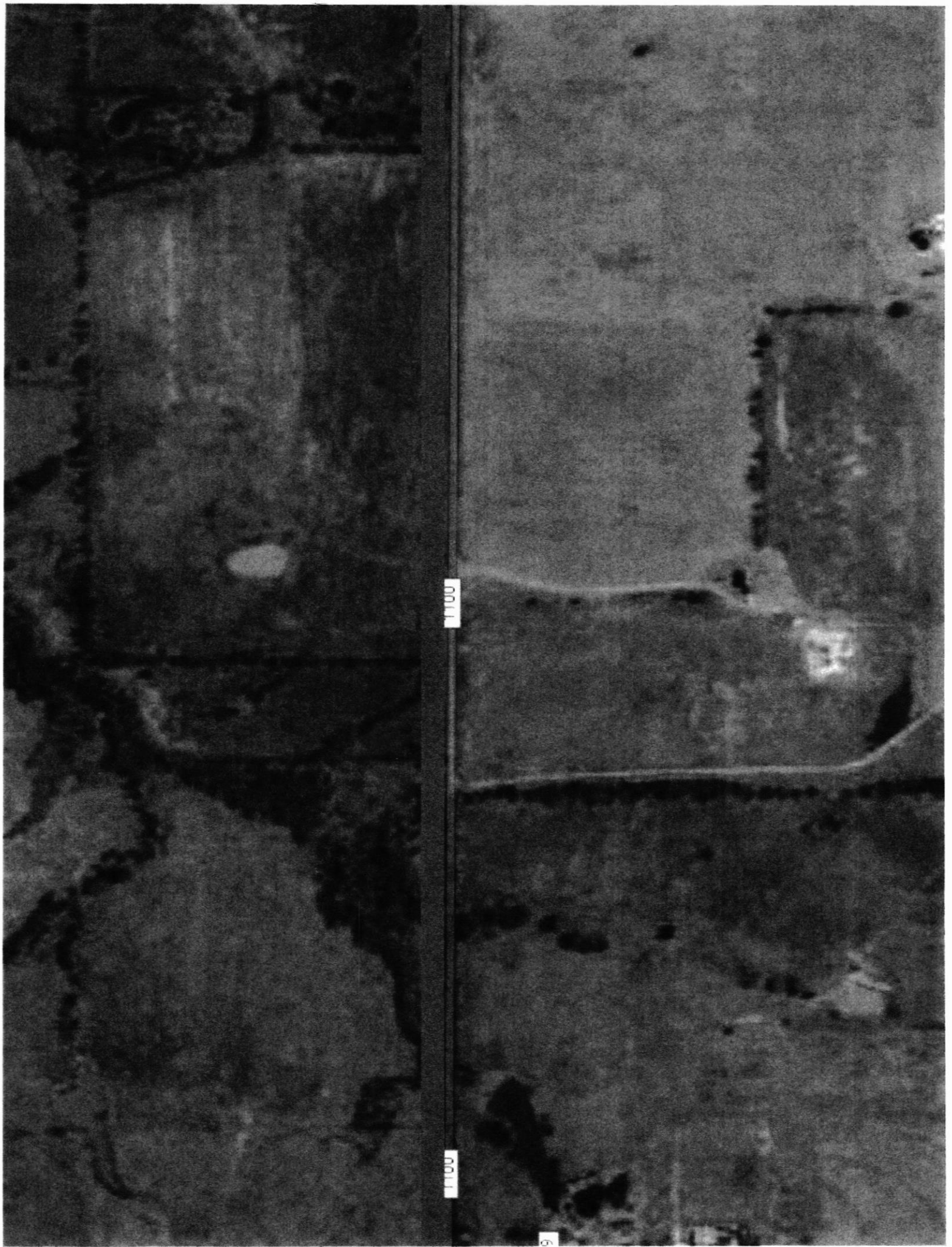

1100

1100

6

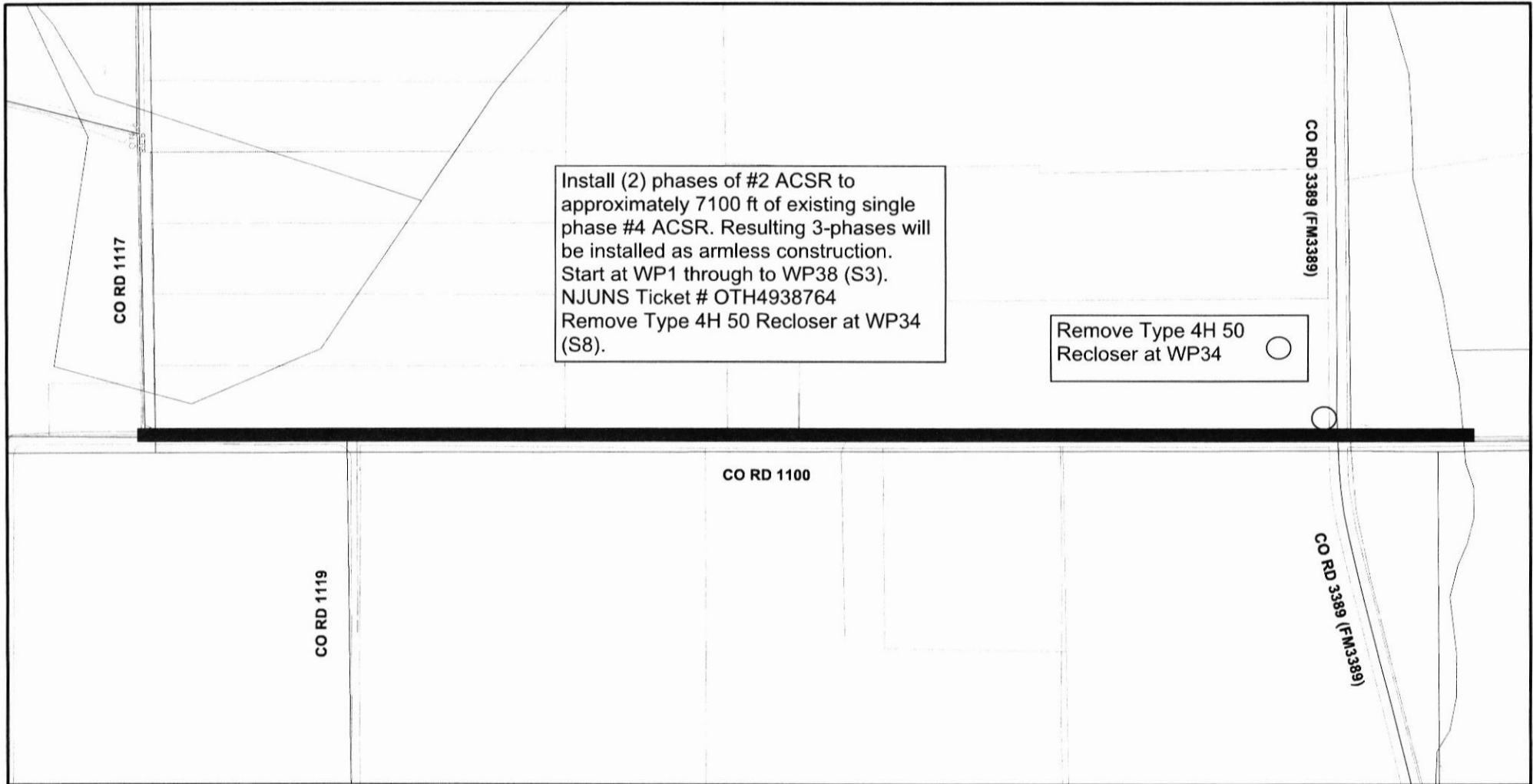

ELECTRIC CONSTRUCTION PRINT

WR Number: **3571383** Date: 2021/11/18 WR Name: SUL 2022NSUL003_CO RD 1100_S3,S8 ADD_PHASE 7100FT PJW
 Sheet: **1** of **9** Scale: 1:600 Customer: ONCOR
 Job Status: **Design** Svc Ctr / Office: SULPHUR SPRINGS / Address: CO RD 1100
 Designer: WILLIAMS, PAUL/U8JV 214 430 7792 Location: SULPHUR SPRINGS, TX 75482
 Project Mgr: JACKSON, JEVIN/U1KS 214 354 4356

Copyright 2018 Oncor Electric Delivery - Maps, drawings, and electronic data (products) are created for the internal purposes of Oncor Electric Delivery with no implication of suitability or fitness for the intended use of the recipient. Oncor Electric Delivery will make good faith efforts to provide products that are free from error, but does not warrant the accuracy or quality of such products. The locations shown are approximations and are not intended to show exact locations. Products provided to other parties by Oncor Electric Delivery are for the internal use of the recipient, and the recipient agrees not to duplicate or distribute the products or any portion of the products to third parties without the prior written permission of Oncor Electric Delivery. The recipient further agrees to hold harmless and indemnify Oncor Electric Delivery against all claims, costs, expenses and damages resulting from or predicated upon strict liability for personal injuries, death or property damage, on account of any defect in the property provided hereunder.



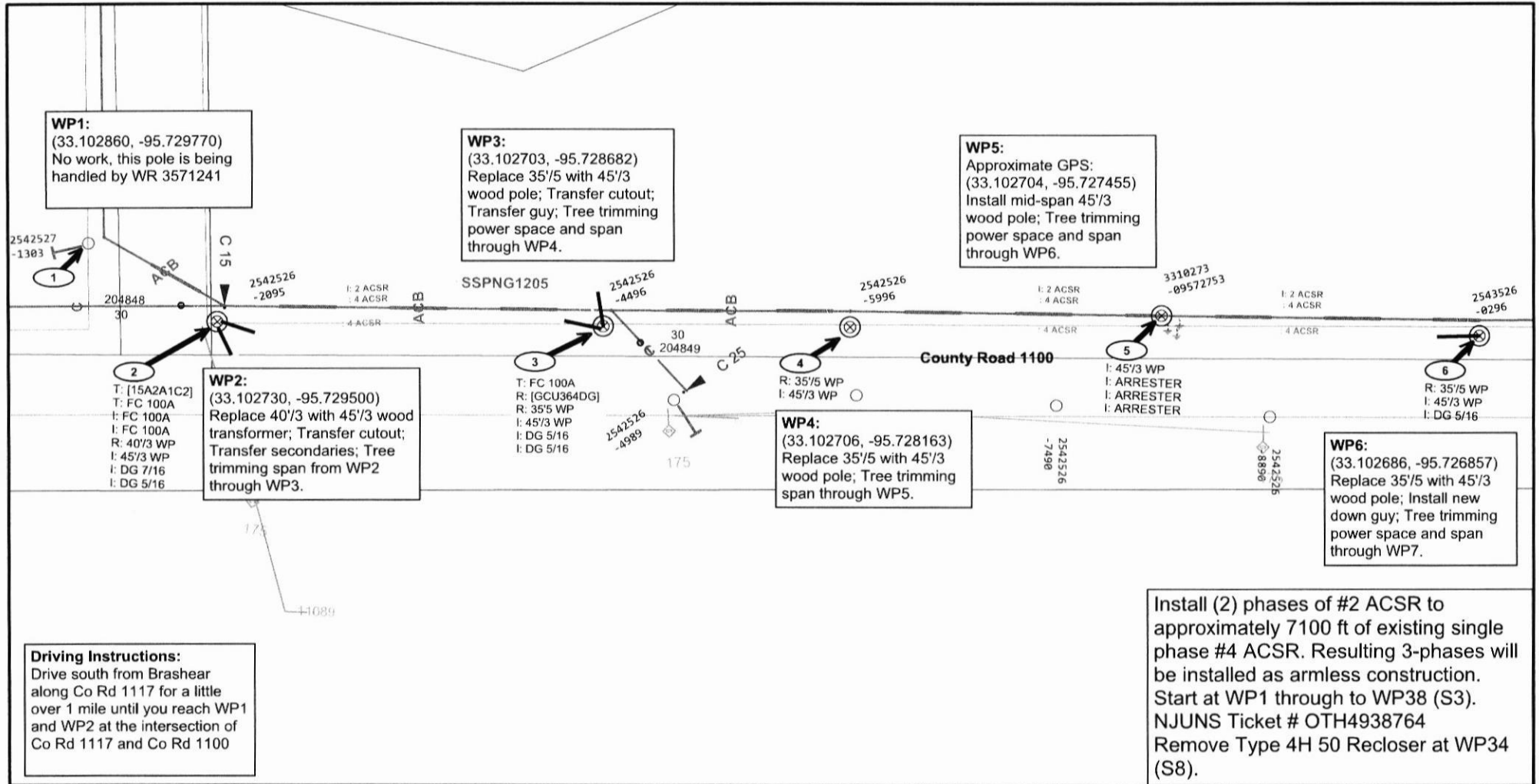

ELECTRIC CONSTRUCTION PRINT

WR Number: **3571383** Date: 2022/02/22 WR Name: SUL 2022NSUL003_CO RD 1100_S3,S8_ADD_PHASE 7100FT PJW
 Sheet: **2** of **9** Scale: 1:70' Customer: **ONCOR**
 Job Status: **Design** Svc Ctr / Office: **SUL/Sulphur Springs** Address: **CO RD 1100**
 Designer: **WILLIAMS, PAUL/U8JV** 214 430 7792 Location: **BRASHEAR, TX 75420**
 Project Mgr: **JACKSON, JEVIN/U1K5** 214 354 4356

Copyright 2018 Oncor Electric Delivery - Maps, drawings, and electronic data (products) are created for the internal purposes of Oncor Electric Delivery with no implication of suitability or fitness for the intended use of the recipient. Oncor Electric Delivery will make good faith efforts to provide products that are free from error, but does not warrant the accuracy or quality of such products. The locations shown are approximations and are not intended to show exact locations. Products provided to other parties by Oncor Electric Delivery are for the internal use of the recipient, and the recipient agrees not to duplicate or distribute the products or any portion of the products to third parties without the prior written permission of Oncor Electric Delivery. The recipient further agrees to hold harmless and indemnify Oncor Electric Delivery against all claims, costs, expenses and damages resulting from or predicated upon strict liability for personal injuries, death or property damage, on account of any defect in the property provided hereunder.



CR 1117 ES

Driving Instructions:
Continue east from WP6
along Co Rd 1100 about
275 ft, passing Co Rd 1119
at WP7.

Install (2) phases of #2 ACSR to
approximately 7100 ft of existing single
phase #4 ACSR. Resulting 3-phases will
be installed as armless construction.
Start at WP1 through to WP38 (S3).
NJUNS Ticket # OTH4938764
Remove Type 4H 50 Recloser at WP34
(S8).

WP7:
(33.102684, -95.725958)
Replace 35/5 with 45/3
wood pole; Transfer cutout;
Install new down guy; Tree
trimming power space and
span through WP8.

WP9:
Approximate GPS:
(33.102676, -95.724858)
Install mid-span 45/3
wood pole; Tree trimming
power space and span
through WP10.

WP11:
Approximate GPS:
(33.102672, -95.723527)
Install mid-span 45/3
wood pole; Tree trimming
power space and span
through WP12.

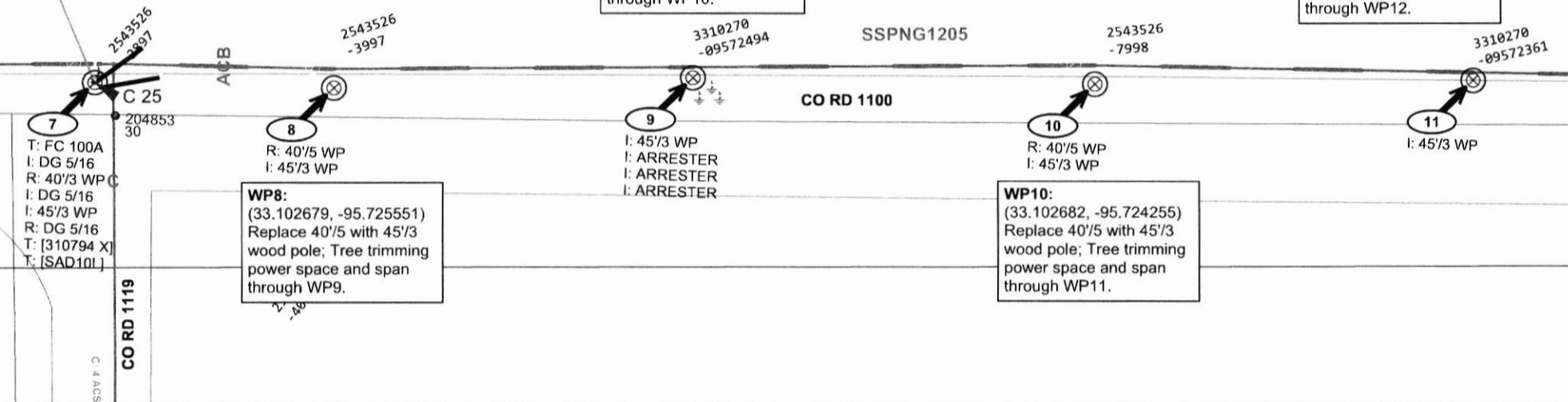

T: FC 100A
L: DG 5/16
R: 40/3 WP
I: DG 5/16
I: 45/3 WP
R: DG 5/16
T: [310794 X]
T: [SAD101]

WP8:
(33.102679, -95.725551)
Replace 40/5 with 45/3
wood pole; Tree trimming
power space and span
through WP9.

WP10:
(33.102682, -95.724255)
Replace 40/5 with 45/3
wood pole; Tree trimming
power space and span
through WP11.

ELECTRIC CONSTRUCTION PRINT

WR Number: **3571383** Date: **2022/02/22** WR Name: **SUL 2022NSUL003_CO RD 1100_S3,S8 ADD_PHASE 7100FT PJW**

Sheet: **3** of **9** Scale: **1:60'** Customer: **ONCOR**

Job Status: **Design** Svc Ctr / Office: **SULPHUR SPRINGS /** Address: **CO RD 1100**

Designer: **WILLIAMS, PAUL/UBJV** 214 430 7792 Location: **BRASHEAR, TX 75420**

Project Mgr: **JACKSON, JEVIN/U1KS** 214 354 4356

Copyright 2018 Oncor Electric Delivery - Maps, drawings, and electronic data (products) are created for the internal purposes of Oncor Electric Delivery with no implication of suitability or fitness for the intended use of the recipient. Oncor Electric Delivery will make good faith efforts to provide products that are free from error, but does not warrant the accuracy or quality of such products. The locations shown are approximations and are not intended to show exact locations. Products provided to other parties by Oncor Electric Delivery are for the internal use of the recipient, and the recipient agrees not to duplicate or distribute the products or any portion of the products to third parties without the prior written permission of Oncor Electric Delivery. The recipient further agrees to hold harmless and indemnify Oncor Electric Delivery against all claims, costs, expenses and damages resulting from or predicated upon strict liability for personal injuries, death or property damage, on account of any defect in the property provided hereunder.



Driving Instructions:
Continue east from WP11
along Co Rd 1100, about
215 ft.

WP12:
(33.102666, -95.722946)
Replace 40'/5 with 45'/3
wood pole; Tree trimming
power space and span
through WP13.

WP14:
(33.102661, -95.721691)
Replace 40'/5 with 45'/3
wood pole; Tree trimming
span through WP15.

WP16:
(33.102643, -95.720339)
Replace 40'/5 with 45'/3
wood pole; Tree trimming
span through WP17.

WP13:
Approximate GPS:
(33.102664, -95.722338)
Install mid-span 45'/3
wood pole; Tree trimming
power space and span
through WP14.

WP15:
Approximate GPS:
(33.102667, -95.721028)
Install mid-span 45'/3
wood pole; Tree trimming
power space and span
through WP16.

Install (2) phases of #2 ACSR to
approximately 7100 ft of existing single
phase #4 ACSR. Resulting 3-phases will
be installed as armless construction.
Start at WP1 through to WP38 (S3).
NJUNS Ticket # OTH4938764
Remove Type 4H 50 Recloser at WP34
(S8).

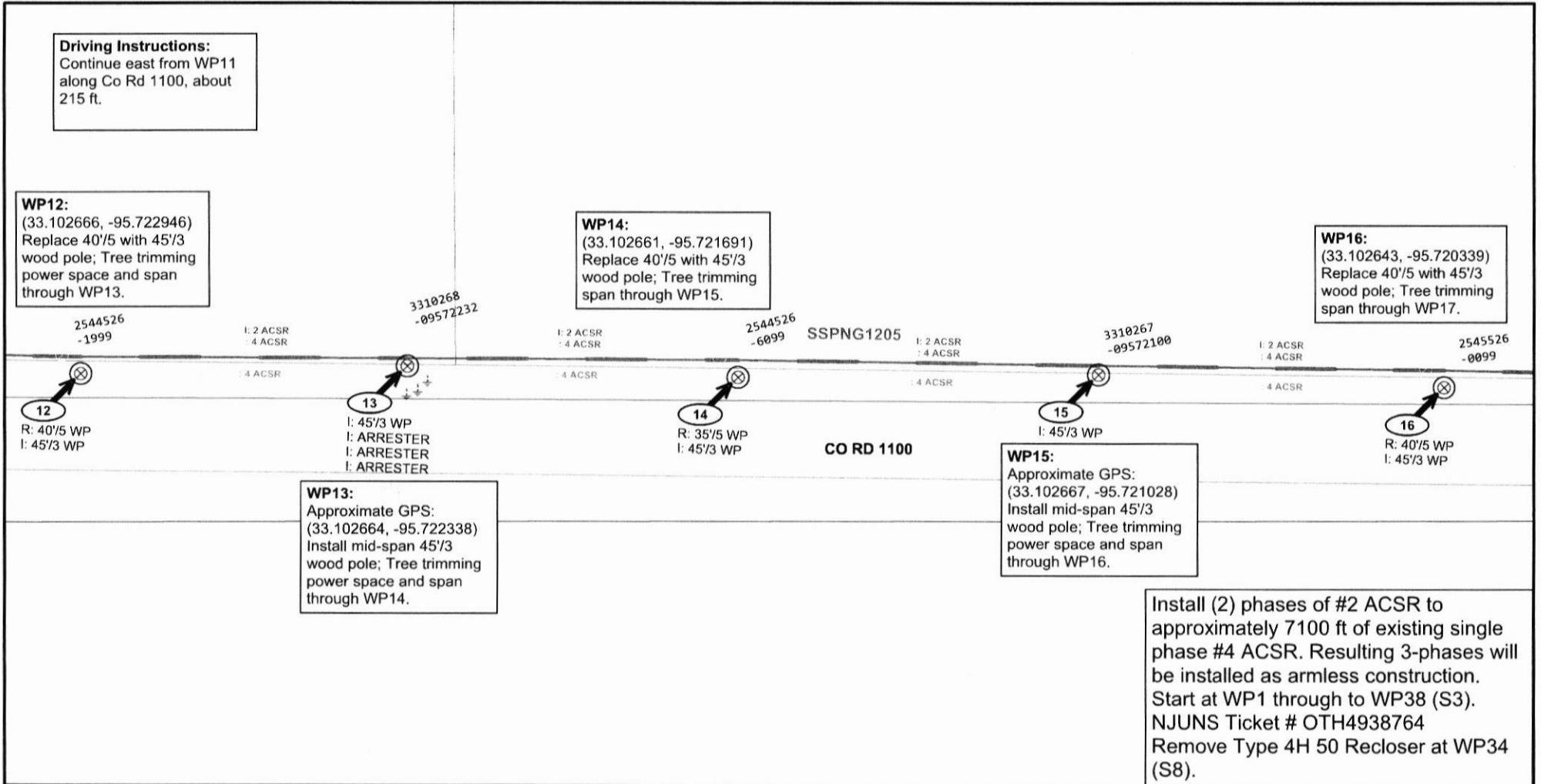

ELECTRIC CONSTRUCTION PRINT

WR Number: **3571383** Date: **2022/02/22** WR Name: **SUL 2022NSUL003_CO RD 1100_53,58 ADD_PHASE 7100FT PJW**
 Sheet: **4** of **9** Scale: **1:65'** Customer: **ONCOR**
 Job Status: **Design** Svc Ctr / Office: **SULPHUR SPRINGS /** Address: **CO RD 1100**
 Designer: **WILLIAMS, PAUL/U8JV** 214 430 7792 Location: **BRASHEAR, TX 75420**
 Project Mgr: **JACKSON, JEVIN/U1KS** 214 354 4356

Copyright 2018 Oncor Electric Delivery - Maps, drawings, and electronic data (products) are created for the internal purposes of Oncor Electric Delivery with no implication of suitability or fitness for the intended use of the recipient. Oncor Electric Delivery will make good faith efforts to provide products that are free from error, but does not warrant the accuracy or quality of such products. The locations shown are approximations and are not intended to show exact locations. Products provided to other parties by Oncor Electric Delivery are for the internal use of the recipient, and the recipient agrees not to duplicate or distribute the products or any portion of the products to third parties without the prior written permission of Oncor Electric Delivery. The recipient further agrees to hold harmless and indemnify Oncor Electric Delivery against all claims, costs, expenses and damages resulting from or predicated upon strict liability for personal injuries, death or property damage, on account of any defect in the property provided hereunder.



Driving Instructions:
Continue east from WP16
along Co Rd 1100, about
200 ft.

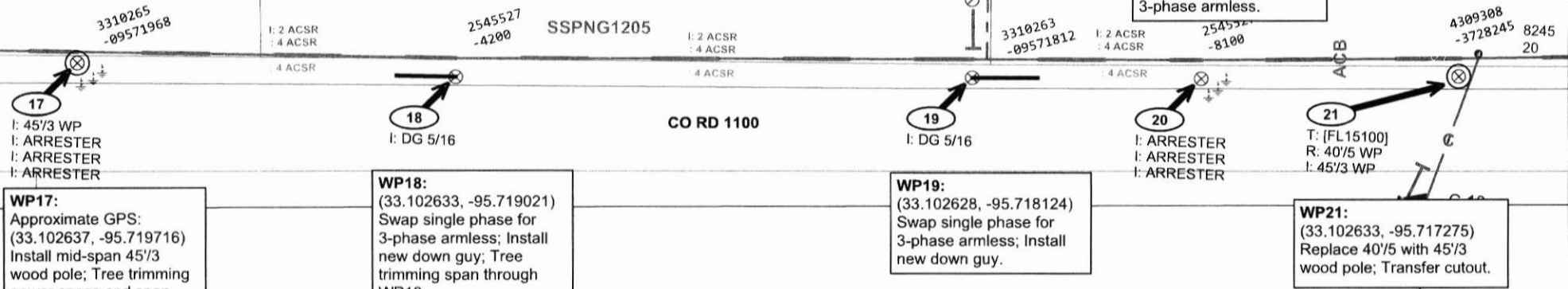

WP17:
Approximate GPS:
(33.102637, -95.719716)
Install mid-span 45/3
wood pole; Tree trimming
power space and span
through WP18.

WP18:
(33.102633, -95.719021)
Swap single phase for
3-phase armless; Install
new down guy; Tree
trimming span through
WP19.

WP19:
(33.102628, -95.718124)
Swap single phase for
3-phase armless; Install
new down guy.

WP20:
(33.102627, -95.717725)
Swap single phase for
3-phase armless.

WP21:
(33.102633, -95.717275)
Replace 40/5 with 45/3
wood pole; Transfer cutout.

Install (2) phases of #2 ACSR to
approximately 7100 ft of existing single
phase #4 ACSR. Resulting 3-phases will
be installed as armless construction.
Start at WP1 through to WP38 (S3).
NJUNS Ticket # OTH4938764
Remove Type 4H 50 Recloser at WP34
(S8).

ELECTRIC CONSTRUCTION PRINT

WR Number: **3571383** Date: **2022/02/22** WR Name: **SUL 2022NSUL003_CO RD 1100_53,58 ADD_PHASE 7100FT PJW**
 Sheet: **5** of **9** Scale: **1:61'** Customer: **ONCOR**
 Job Status: **Design** Svc Ctr / Office: **SUL/Sulphur Springs** Address: **CO RD 1100**
 Designer: **WILLIAMS, PAUL/U8JV** 214 430 7792 Location: **BRASHEAR, TX 75420**
 Project Mgr: **JACKSON, JEVIN/U1K5** 214 354 4356

Copyright 2018 Oncor Electric Delivery. Maps, drawings, and electronic data (products) are created for the internal purposes of Oncor Electric Delivery with no implication of suitability or fitness for the intended use of the recipient. Oncor Electric Delivery will make good faith efforts to provide products that are free from error, but does not warrant the accuracy or quality of such products. The locations shown are approximations and are not intended to show exact locations. Products provided to other parties by Oncor Electric Delivery are for the internal use of the recipient, and the recipient agrees not to duplicate or distribute the products or any portion of the products to third parties without the prior written permission of Oncor Electric Delivery. The recipient further agrees to hold harmless and indemnify Oncor Electric Delivery against all claims, costs, expenses and damages resulting from or predicated upon strict liability for personal injuries, death or property damage, on account of any defect in the property provided hereunder.



Driving Instructions:
Continue east from WP21
along Co Rd 1100, about
250 ft.

Install (2) phases of #2 ACSR to
approximately 7100 ft of existing single
phase #4 ACSR. Resulting 3-phases will
be installed as armless construction.
Start at WP1 through to WP38 (S3).
NJUNS Ticket # OTH4938764
Remove Type 4H 50 Recloser at WP34
(S8).

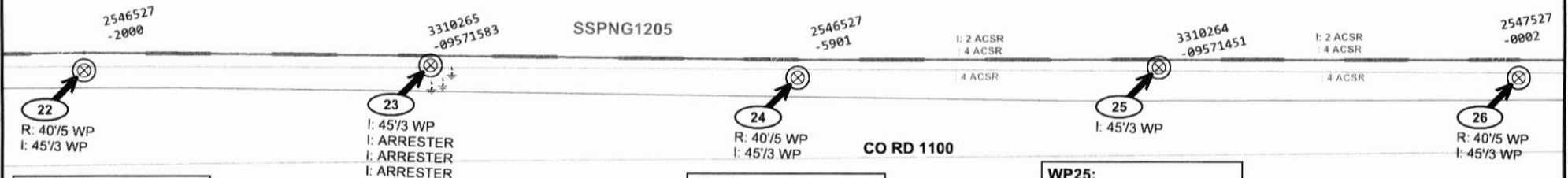

WP22:
(33.102633, -95.716451)
Replace 40/5 with 45/3
wood pole.

WP23:
Approximate GPS:
(33.102633, -95.715804)
Install mid-span 45/3
wood pole.

WP24:
(33.102619, -95.715157)
Replace 40/5 with 45/3
wood pole.

WP25:
Approximate GPS:
(33.102621, -95.714456)
Install mid-span 45/3
wood pole.

WP26:
(33.102617, -95.713848)
Replace 40/5 with 45/3
wood pole.

ELECTRIC CONSTRUCTION PRINT

WR Number: **3571383** Date: **2022/02/22** WR Name: **SUL 2022NSUL003_CO RD 1100_S3,S8 ADD_PHASE 7100FT PJW**
 Sheet: **6** of **9** Scale: **1:63'** Customer: **ONCOR**
 Job Status: **Design** Svc Ctr / Office: **SUL/Sulphur Springs** Address: **CO RD 1100**
 Designer: **WILLIAMS, PAUL/U8JV** 214 430 7792 Location: **BRASHEAR, TX 75420**
 Project Mgr: **JACKSON, JEVIN/U1K5** 214 354 4356

Copyright 2018 Oncor Electric Delivery. Maps, drawings, and electronic data (products) are created for the internal purposes of Oncor Electric Delivery with no implication of suitability or fitness for the intended use of the recipient. Oncor Electric Delivery will make good faith efforts to provide products that are free from error, but does not warrant the accuracy or quality of such products. The locations shown are approximations and are not intended to show exact locations. Products provided to other parties by Oncor Electric Delivery are for the internal use of the recipient, and the recipient agrees not to duplicate or distribute the products or any portion of the products to third parties without the prior written permission of Oncor Electric Delivery. The recipient further agrees to hold harmless and indemnify Oncor Electric Delivery against all claims, costs, expenses and damages resulting from or predicated upon strict liability for personal injuries, death or or property damage, on account of any defect in the property provided hereunder.



Driving Instructions:
Continue east from WP26
along Co Rd 1100, about
200 ft.

WP31:
Approximate GPS:
(33.102623, -95.710445)
Install mid-span 45/3
wood pole; Tree trimming
power space and span
through WP32.

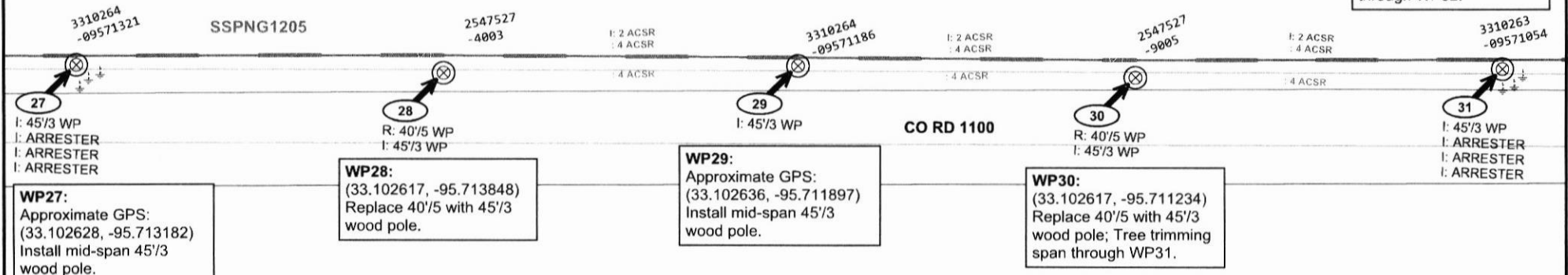

Install (2) phases of #2 ACSR to
approximately 7100 ft of existing single
phase #4 ACSR. Resulting 3-phases will
be installed as armless construction.
Start at WP1 through to WP38 (S3).
NJUNS Ticket # OTH4938764
Remove Type 4H 50 Recloser at WP34
(S8).

ELECTRIC CONSTRUCTION PRINT

WR Number: **3571383** Date: **2022/02/22** WR Name: **SUL 2022NSUL003_CO RD 1100_S3,S8 ADD_PHASE 7100FT PJW**
Sheet: **7** of **9** Scale: **1:65"** Customer: **ONCOR**
Job Status: **Design** Svc Ctr / Office: **SUL/Sulphur Springs** Address: **CO RD 1100**
Designer: **WILLIAMS, PAUL/U8JV** 214 430 7792 Location: **BRASHEAR, TX 75420**
Project Mgr: **JACKSON, JEVIN/U1K5** 214 354 4356

Copyright 2018 Oncor Electric Delivery. Maps, drawings, and electronic data (products) are created for the internal purposes of Oncor Electric Delivery with no implication of suitability or fitness for the intended use of the recipient. Oncor Electric Delivery will make good faith efforts to provide products that are free from error, but does not warrant the accuracy or quality of such products. The locations shown are approximations and are not intended to show exact locations. Products provided to other parties by Oncor Electric Delivery are for the internal use of the recipient, and the recipient agrees not to duplicate or distribute the products or any portion of the products to third parties without the prior written permission of Oncor Electric Delivery. The recipient further agrees to hold harmless and indemnify Oncor Electric Delivery against all claims, costs, expenses and damages resulting from or predicated upon strict liability for personal injuries, death or property damage, on account of any defect in the property provided hereunder.



IT IS THE RESPONSIBILITY OF THE UTILITY TO NOTIFY TXDOT VIA THE UIR SYSTEM 48 HOURS PRIOR TO START OF CONSTRUCTION.

CONTRACTORS, YOU ARE TO CALL:
 1. ROY SMITH FOR UIR ELECTRONIC NOTIFICATION.
 2. THE TXDOT INSPECTOR NOTED ON THE APPROVED PERMIT 48 HOURS PRIOR TO THE START OF CONSTRUCTION.

UIR ELECTRONIC NOTIFICATION CONTACT
 ROY SMITH
 EMAIL: Roy.Smith@powering.com
 PHONE: (817) 882-4768

POLE MATERIAL: WOOD UNLESS OTHERWISE NOTED
 POLE DIAMETER: 12"-17" UNLESS OTHERWISE NOTED
 ALL POLES WILL BE INSTALLED NO CLOSER THAN 3' WITHIN THE ROW

Driving Instructions:
 Drive to the intersection of Co Rd 1100 and Co Rd 3389 (FM3389).

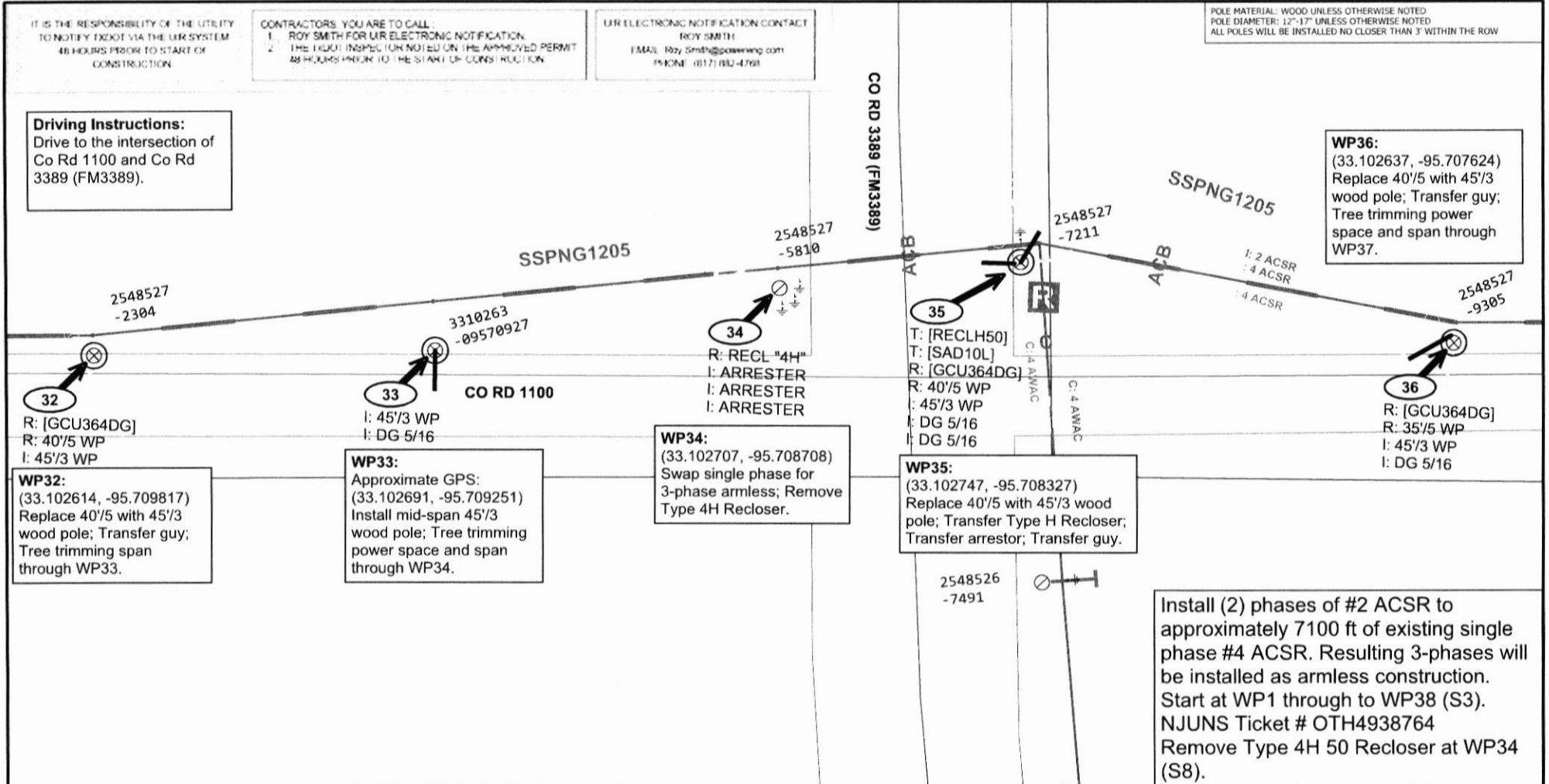

WP32:
 (33.102614, -95.709817)
 Replace 40/5 with 45/3 wood pole; Transfer guy; Tree trimming span through WP33.

WP33:
 Approximate GPS: (33.102691, -95.709251)
 Install mid-span 45/3 wood pole; Tree trimming power space and span through WP34.

WP34:
 (33.102707, -95.708708)
 Swap single phase for 3-phase armless; Remove Type 4H Recloser.

WP35:
 (33.102747, -95.708327)
 Replace 40/5 with 45/3 wood pole; Transfer Type H Recloser; Transfer arrester; Transfer guy.

WP36:
 (33.102637, -95.707624)
 Replace 40/5 with 45/3 wood pole; Transfer guy; Tree trimming power space and span through WP37.

Install (2) phases of #2 ACSR to approximately 7100 ft of existing single phase #4 ACSR. Resulting 3-phases will be installed as armless construction. Start at WP1 through to WP38 (S3). NJUNS Ticket # OTH4938764 Remove Type 4H 50 Recloser at WP34 (S8).

ELECTRIC CONSTRUCTION PRINT

WR Number: **3571383** Date: 2022/02/22 WR Name: SUL 2022NSUL003_CO RD 1100_S3,S8_ADD_PHASE 7100FT PJW
 Sheet: **8** of **9** Scale: 1:55' Customer: ONCOR
 Job Status: Design Svc Ctr / Office: SULPHUR SPRINGS / Address: CO RD 1100
 Designer: WILLIAMS, PAUL/UBJV 214 430 7792 Location: SULPHUR SPRINGS, TX 75482
 Project Mgr: JACKSON, JEVIN/U1KS 214 354 4356

Copyright 2018 Oncor Electric Delivery - Maps, drawings, and electronic data (products) are created for the internal purposes of Oncor Electric Delivery with no implication of suitability or fitness for the intended use of the recipient. Oncor Electric Delivery will make good faith efforts to provide products that are free from error, but does not warrant the accuracy or quality of such products. The locations shown are approximations and are not intended to show exact locations. Products provided to other parties by Oncor Electric Delivery are for the internal use of the recipient, and the recipient agrees not to duplicate or distribute the products or any portion of the products to third parties without the prior written permission of Oncor Electric Delivery. The recipient further agrees to hold harmless and indemnify Oncor Electric Delivery against all claims, costs, expenses and damages resulting from or attributed upon strict liability for personal injuries, death or property damage, on account of any defect in the property provided hereunder.



Driving Instructions:
Continue east from WP36
along Co Rd 1100, about
150 ft.

SSPNG1205

3310265
-09570713

I: 2 ACSR
: 4 ACSR
: 4 ACSR

2549527
-2306

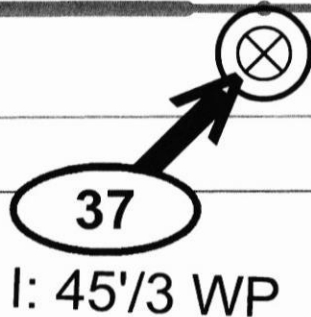

WP37:
Approximate GPS:
(33.102644, -95.707120)
Install mid-span 45'3
wood pole; Tree trimming
power space and span
through WP38.

CO RD 1100

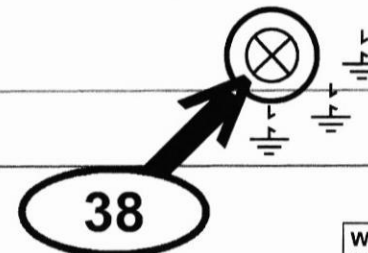

WP38:
(33.102636, -95.706636)
Replace 35'5 with 45'3
wood pole.

R: 35'5 WP
I: 45'3 WP
I: ARRESTER
I: ARRESTER
I: ARRESTER

Install (2) phases of #2 ACSR to
approximately 7100 ft of existing single
phase #4 ACSR. Resulting 3-phases will
be installed as armless construction.
Start at WP1 through to WP38 (S3).
NJUNS Ticket # OTH4938764
Remove Type 4H 50 Recloser at WP34
(S8).

ELECTRIC CONSTRUCTION PRINT

WR Number: **3571383** Date: 2022/02/22 WR Name: SUL 2022NSUL003_CO RD 1100_S3,S8 ADD_PHASE 7100FT PJW
Sheet: **9** of **9** Scale: 1:20" Customer: **ONCOR**
Job Status: **Design** Svc Ctr / Office: **SUL/Sulphur Springs** Address: **CO RD 1100**
Designer: **WILLIAMS, PAUL/U8JV** 214 430 7792 Location: **SULPHUR SPRINGS, TX 75482**
Project Mgr: **JACKSON, JEVIN/U1KS** 214 354 4356

Copyright 2018 Oncor Electric Delivery - Maps, drawings, and electronic data (products) are created for the internal purposes of Oncor Electric Delivery with no implication of suitability or fitness for the intended use of the recipient. Oncor Electric Delivery will make good faith efforts to provide products that are free from error, but does not warrant the accuracy or quality of such products. The locations shown are approximations and are not intended to show exact locations. Products provided to other parties by Oncor Electric Delivery are for the internal use of the recipient, and the recipient agrees not to duplicate or distribute the products or any portion of the products to third parties without the prior written permission of Oncor Electric Delivery. The recipient further agrees to hold harmless and indemnify Oncor Electric Delivery against all claims, costs, expenses and damages resulting from or predicated upon strict liability for personal injuries, death or or property damage, on account of any defect in the property provided hereunder.

